

B1 RKM 15002

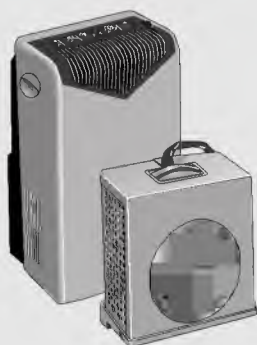

DE Gebrauchsanweisung
GB Instructions for Use
FR Mode d'emploi
NL Gebruiksaanwijzing
IT Istruzioni sull'uso
ES Instrucciones de manejo
PT Instruções de uso



Household Appliances

Internet: <http://www.bosch-hausgeraete.de>

Bosch Info-Team: DE Tel. 01 80/5 30 40 50 (€ 0,13 • DEM 0,24/Min. DTAG)

BOSCH

Robert Bosch Hausgeräte GmbH
Carl-Wery-Str. 34
D 81739 München
Germany

Index

Important Observations

Disposal of packaging	25
Disposal of your old appliance	25
Before connecting your new appliance	25

Your new appliance

Description of your appliance	26
Control panel	27
Accessories.....	27

Requirements for use

Transportation requirements.....	29
----------------------------------	----

Preparations

Positioning of the outdoor unit	30
Indoor/outdoor unit communication.....	31
Separating the flexible duct from the indoor unit ...	32
Connecting the flexible duct to the indoor unit	34

Turning the appliance on

Cooling and Dehumidification	35
Only dehumidification.....	35
Air purification	36

Setting the time / Programming the timer

Setting the time	37
Setting the timer	37
Disconnecting the timer.....	38

Cleaning and Maintenance

Technical service / Warranty

Things that can save you from making unnecessary phone calls	41
--	----

Technical information	43
-----------------------------	----

Important Observations

Disposal of packaging

- ☐ Respect the environment when disposing of the material your appliance comes packed in.
- ☐ Our products are all carefully packed for transportation purposes. The packaging is designed to not harm the environment. All the materials used in the production of this packaging are environmentally friendly or can be re-used.
- ☐ Recycling the material your appliance comes packed in helps contribute to the conservation of raw materials and reduces the amount of waste produced in the world.
- ☐ It may be possible to return packaging to the establishment that supplied you with your appliance. Contact them for more information.

Disposal of your old appliance

- ☐ Unplug your old appliance from the mains electricity supply and cut the power cable.
- ☐ Appliances of this kind contain refrigerants which need to be disposed of in accordance with current regulations.
- ☐ Do not dispose of your old appliance yourself. Get in touch with your local council or other competent body for information about how best to dispose of it.

Before connecting your new appliance

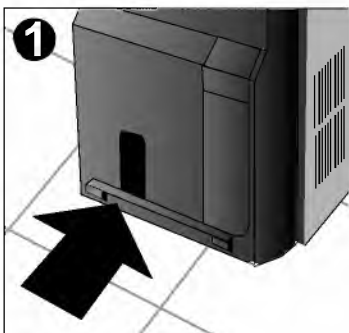

- ☐ Read the instructions book before using your appliance for the first time. It contains important information, not only concerning use, but maintenance and personal safety as well.
- ☐ Keep this instructions book. It may be useful for later owners.
- ☐ Do not turn a damaged appliance on.
- ☐ Your appliance must be assembled and connected in accordance with the assembly instructions and current regulations. If these instructions are not observed, you run the risk of losing your warranty.
- ☐ All our appliances are made in accordance with present-day safety regulations. Only technicians instructed in these matters are authorised to repair them. Your safety is at stake.
- ☐ Make sure that the drainage plugs are properly inserted. They may have come loose during transportation, **Fig. 1**.

Your new appliance

Description of your appliance

Indoor Unit

Main filter

Condensed water drainage pipe

Wire cavity

Plugged nozzle to drain condensed water

Purifying filters

Air-conditioning appliance

Air-intake grille

Characteristics plate

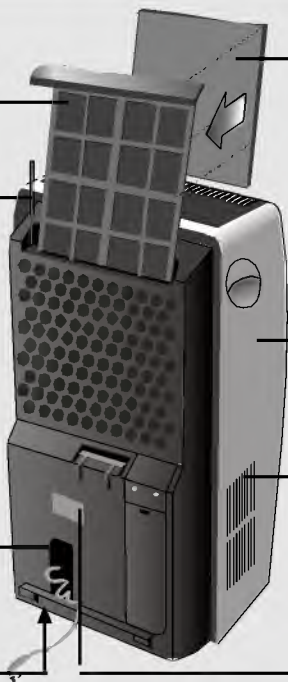

Outdoor unit

Flexible duct to connect indoor and outdoor units

Plugged nozzle to drain water produced by condensation in "Dehumidification" mode



Control panel

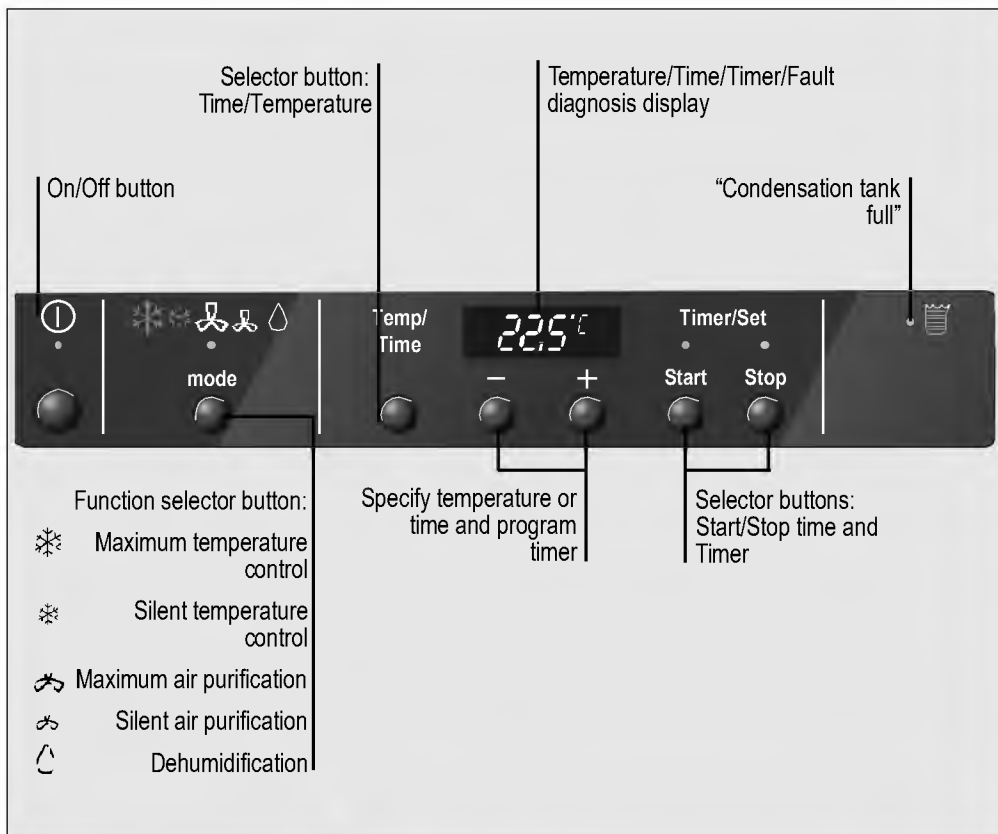

Accessories

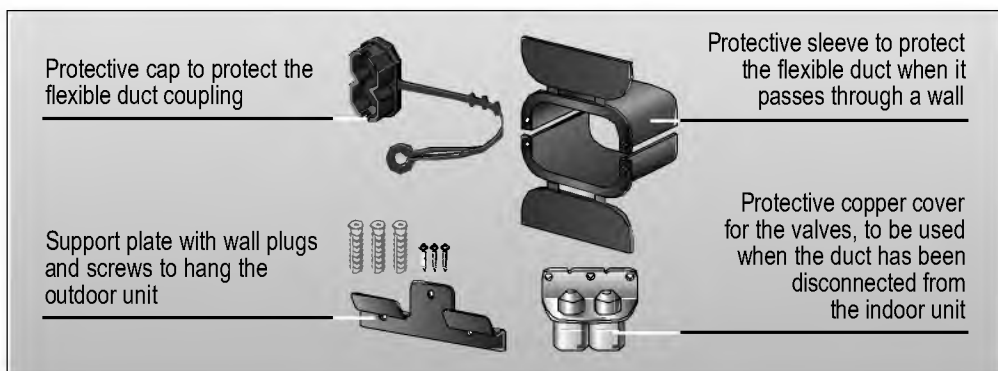

Requirements for Use

Requirements for use

- ☐ This appliance must be connected to a 220/240 V 50 Hz mains electricity supply using an earthed plug.
- ☐ It must be protected with a **16 A** slow-action fuse.
- ☐ Should an extension lead be needed, this lead must be at least 1,5 mm² per terminal thick, no more than 25 m. long and earthed.
- ☐ There is a cavity at the back of the appliance for the mains electricity supply connection wire.
- ☐ Do not allow water to enter the appliance.
- ☐ Do not block the air inlets or outlets on your appliance, especially when used for heating.

Should the mains electricity supply wire be damaged in any way, it must only be replaced with a wire of similar characteristics. Get in touch with the manufacturer, after-sales service or similarly qualified person.

Warning!

If the appliance is turned off and then turned back on again, there is a 3-minute interval before the compressor starts up again. This interval is necessary in order for the appliance to work properly.

Transportation requirements

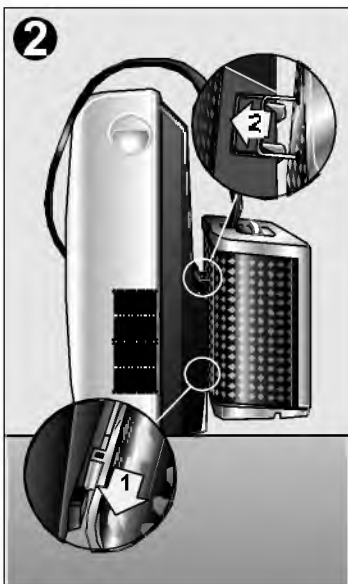

- ❑ The indoor appliance is mounted on castors to facilitate transportation. To transport the outdoor appliance together with the indoor appliance, hang the outdoor appliance in the park position on the indoor appliance - the appliance can then be moved without difficulty, **Fig. 2**.
- ❑ There are castors fitted on your appliance to make moving it easier. If it is necessary to tilt your appliance in order to move it, then the internal water tank must be drained first. To do this, connect drainage pipe to stopcock at the bottom of the appliance, **Fig. 3**.
- ❑ If only the outdoor appliance is transported, first pull the stopper out of the outdoor appliance, tilt the outdoor appliance slightly and pour out the remaining water.

Warning!

Be particularly careful when transporting this unit. There is a water drainage pipe on the bottom of the appliance which may break if knocked.

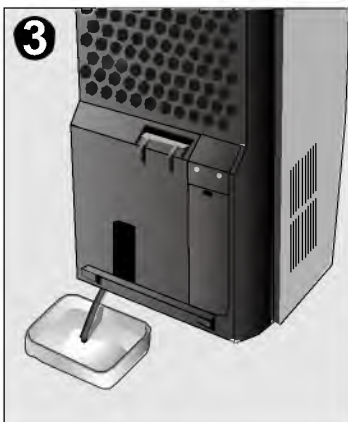

Preparations

Positioning of the outdoor unit

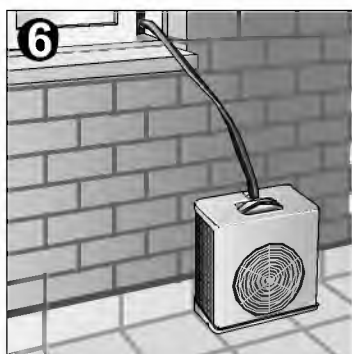
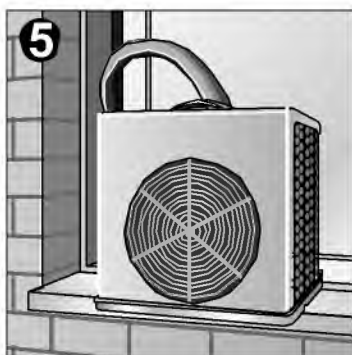
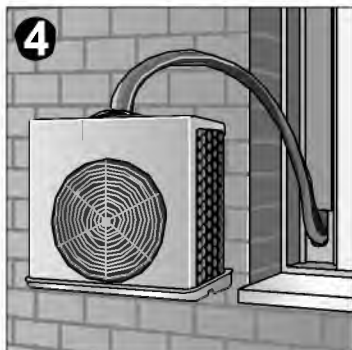

- ❑ The outdoor unit can be set in any of the three positions shown in figures 4, 5 and 6 as desired depending on space conditions. Remember that the outdoor unit must be placed on a horizontal surface. Use the Support Plate accessory in order to hang the outdoor unit from the hook it comes supplied with.

Warning!

- ❑ Make sure that the appliance is hung in a horizontal position, else the lower tray may shed water. To do so, adjust the rear bar on the outdoor unit.
- ❑ For safety reasons, never allow the outdoor unit to hang solely from the duct that joins it with the indoor unit.
- ❑ Do not set the outdoor unit higher than permitted. Observe the minimum permitted distances between the appliance and other objects. See figure 7.
- ❑ Do not impede or twist the flexible duct that joins the two units.

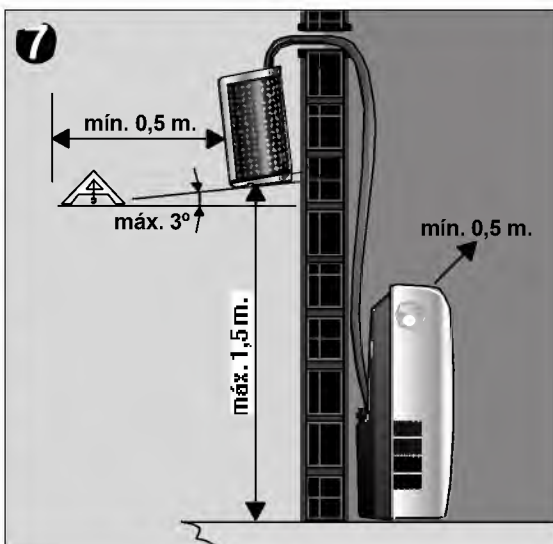

Indoor/outdoor unit communication

The two units are joined by a flexible duct which affords a number of installation options:

- ☐ Pass the duct through a door or window left ajar, **Fig. 8**.
- ☐ Make a 4 x 2-cm hole in a door or window frame to pass the duct through, thereby avoiding having to leave the door or window open, **Fig. 9**.
- ☐ Make a hole in the wall and fit the Protective sleeve accessory, **Fig. 10, 11 and 12**.

The covers on the accessory can be closed when the appliance is not in use or not required, thereby sealing the hole in the wall, **Fig. 12**.

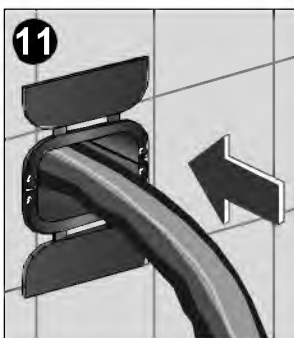
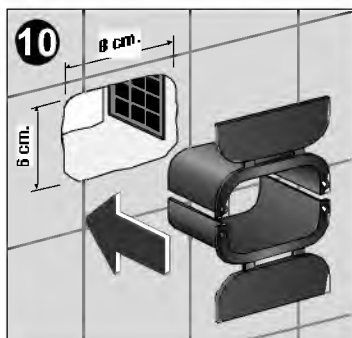
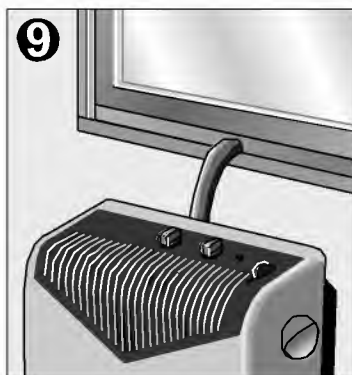
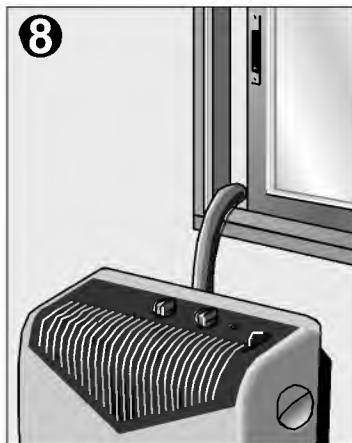

Separating the flexible duct from the indoor unit

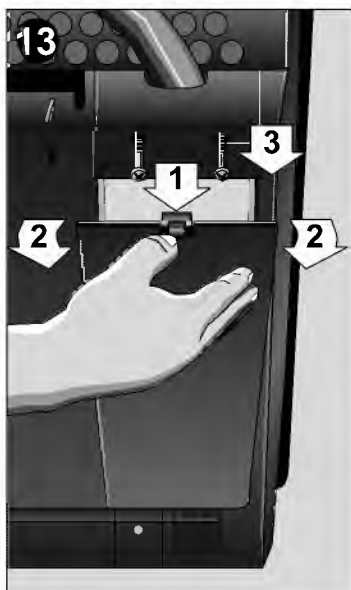

Disconnecting the flexible duct

To pass the duct through a window frame or wall, it must first be disconnected from the indoor unit. On certain models, this can be done via fast connection, proceeding as follows:

- ☐ Unplug the appliance from the mains electricity supply.
- ☐ Remove the lower cover from the connection area and the screws from the upper cover. The flexible duct connection area can now be seen, **Fig. 13**.
- ☐ Remove the electrical connection by squeezing the upper and lower tabs on the plug. See **Fig. 14**.
- ☐ Disassemble the condensed water drainage pipe by turning it 90° in an anti-clockwise direction and extracting, **Fig. 15**.
- ☐ Push the fast connection lever down, **Fig. 16**.
- ☐ Push the metal coupling fixture down, **Fig. 17**, and pull the duct upwards at the same time, **Fig. 18**.

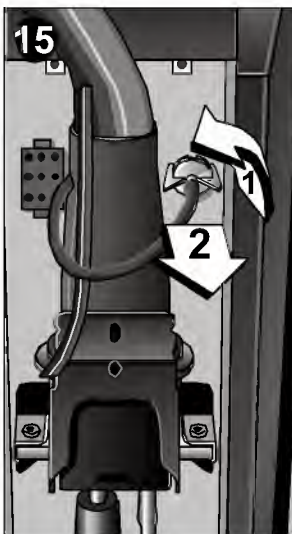
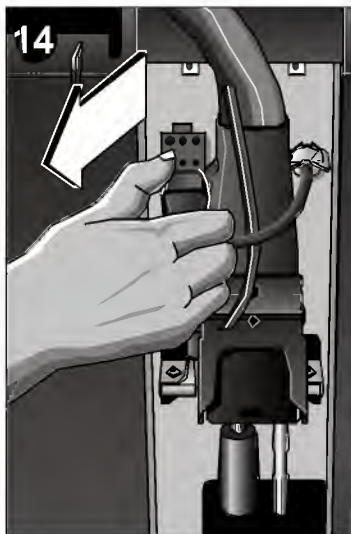

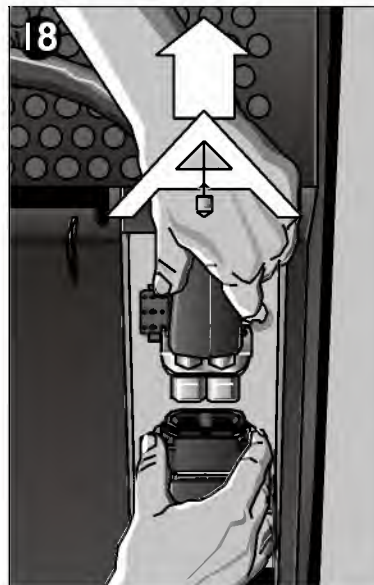
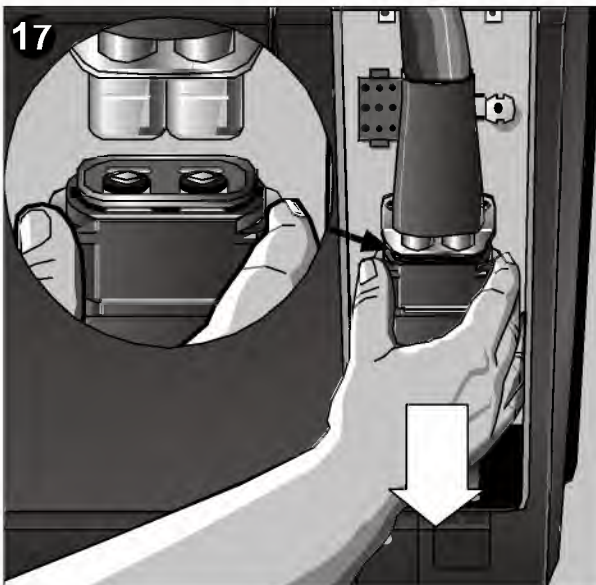

Connecting the flexible duct to the indoor unit

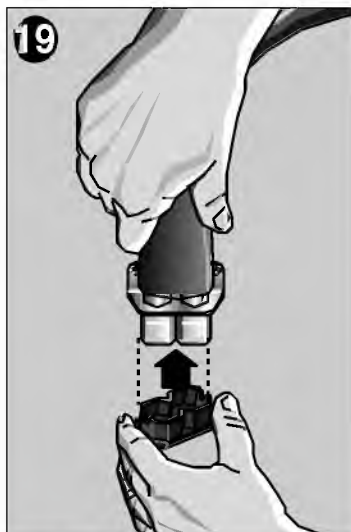

Reconnect the flexible duct to the indoor unit by following the inverse process to that just described.

Warning!

- ☐ The fast connection can only be mounted in one position, see Figure 18. It must only be inserted in its housing in a vertical position.
- ☐ Exerting a little force, pull up the lever until it is vertical. Only then is the hose connected correctly.
- ☐ Should the indoor and outdoor units be disconnected for a lengthy period of time, protect the free end of the flexible duct using the protective cap (See Accessories and Fig. 19) supplied to prevent dust and dirt from entering and fit the protective copper cover over the valves, Fig. 20. You are recommended not to leave the duct disconnected from the indoor unit for more than 24 hours.
- ☐ Never operate the indoor appliance without the outdoor appliance.

Turning the appliance on

Cooling and Dehumidification

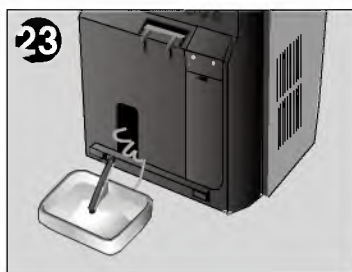
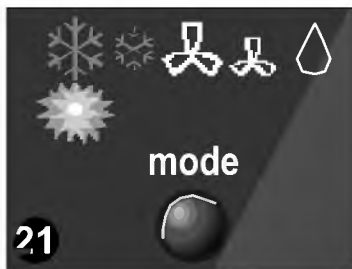

- ☐ Plug the appliance into the mains electricity supply.
- ☐ Turn the appliance on using the "On/Off" button.
- ☐ Select either the "Maximum cooling" ❄️ or the "Silent cooling" 🌙 option, via the "mode" button, **Fig. 21**.
- ☐ Set the thermostat to the desired temperature with buttons ➡️ and ⬅️, **Fig. 22**.
- ☐ The appliance cools and dehumidifies the air in the room at the same time in order to produce pleasant air conditions.
- ☐ Should the appliance turn itself off by effect of the thermostat, it will come back on again when room temperature rises 2°C.
- ☐ The water produced during this process by condensation is led outside and released from the condenser by evaporation.

If the red warning light comes on:

- ☐ Condensed water has unduly accumulated in the tank on the indoor unit.
- ☐ Condensed water is emptied using the flexible drainage pipe, which is coupled onto the water drainage nozzle on the bottom of the appliance, (see description of your appliance, page 26). **Fig. 23**.
- ☐ Make sure that the flexible duct which joins the two units has not been squashed or been trapped in any way. The difference in height between the two units should not exceed 1.5 m. **Fig. 7**.

Only dehumidification

Set the function at this setting, the appliance will only reduce the humidity present in the atmosphere, without affecting the temperature. The appliance is capable of extracting up to 60 litres of water a day from the air depending on atmospheric conditions.

- ☐ Release the water from the outdoor unit by removing the plug from the lower tray.



- ☐ Move the outdoor unit to the room that you wish to dehumidify
- ☐ Connect the flexible water drainage pipe to the drainage nozzle on the outdoor unit and collect the water produced by condensation in a suitable receptacle, **Fig. 25.**
- ☐ Turn the appliance on using the "On/Off" button.
- ☐ Select the "Dehumidification" function . **Fig. 24.**

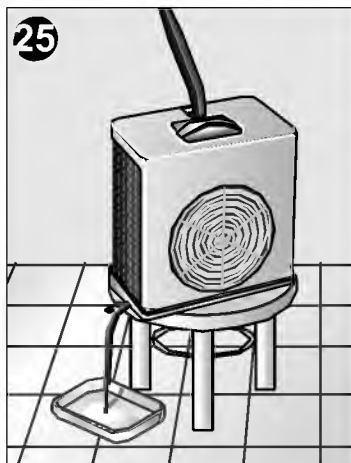

- ☐ When set to this function, the temperature on the display screen is set at "18°C". Should room temperature go down below 18°C, the appliance will not work.

Warning!



When you change back to the "Cooling" function, put the plug back into the drainage nozzle on the outdoor unit. Should you fail to do so, the appliance will shed water produced by condensation during the cooling process.

Always remember that in order for the dehumidification function to work properly, ambient temperature must be at least 18°C.

Air purification



This function circulates the air inside the room passing it through a set of purifying filters in so doing.

- ☐ The appliance comes with a main filter with a double active purifying filter. **Fig. 27.**
This special filter is for:
 - Smells and smoke.
 - Pollen, bacteria and dust.
- ☐ Turn the appliance on using the "On/Off" button.
- ☐ Select the ventilation speed: maximum  or silent , **Fig. 26.**
- ☐ We recommend you leave the optional filters in position regardless of the desired function setting. The appliance purifies the air more efficiently in this way.

Setting the time/Programming the timer

Setting the time

- ☐ With the appliance on, the present time currently set can be displayed by pressing the **"Temp / Time"** button.
The present time is then displayed on the digital screen for a period of 5 seconds with the two dots flashing.
- ☐ The present time displayed on the screen can be altered using the **⊕** and **⊖** buttons. Each time one of these buttons is pressed the present time is put forwards or back one minute. The present time can be altered continuously by keeping these buttons pressed in.
- ☐ Unless another button is pressed in the meantime, 5 seconds after the present time has been set, the temperature will reappear on the display screen.

Setting the timer

(To turn air conditioning on and off automatically). Then the timer can be programmed to turn the air conditioning on and off at set times – regardless of whether the air conditioning is working at the time of setting or not.



- ☐ Press the **"Start"** or **"Stop"** button: The last timer setting will appear on the display screen. The timer light comes on to indicate that the timer has been activated.
- ☐ Press the **⊕** or **⊖** button in order to alter the timer setting. The timer is set in blocks of 15 minutes.

- ❑ 5 seconds after the timer has been set, the set temperature will reappear on the display screen.
- ❑ When the **"on"** and **"off"** times set on the timer are shown on the display screen, the two dots do not flash.

Disconnecting the timer

- ❑ Press the **Start / Stop** buttons for a period of two seconds. The timer light goes out. The timer deactivated.
- ❑ The times and functions set on the timer remain active and the programmed operation will be repeated at the set times until deactivated or cancelled as described above.

Cleaning and Maintenance

Cleaning

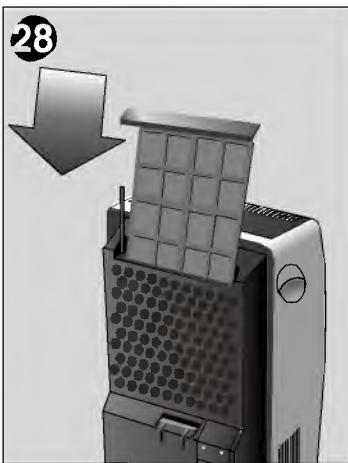
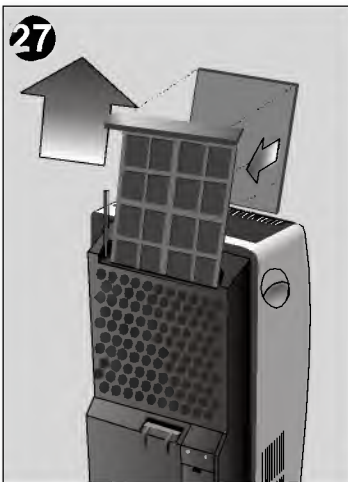

- ☐ The indoor unit features a main filter, which must be cleaned after prolonged operation. Flush under running water, allow to dry and re-install.
- ☐ The set of additional purifying filters, reference **B1 RKZ 15013**, must be replaced with a new set every year in order to work efficiently. Contact your supplier
- ☐ The filters must be fitted as shown in figures **27** and **28**.
- ☐ The appliance can be cleaned with a cloth or sponge, warm water and mild detergent.
- ☐ Never use hot water (more than 40°C), bleach, petrol-based products, acids or brushes when cleaning your appliance. Prevent water entering the appliance.
- ☐ Do not clean your appliance with a hose.

Prior to use at change of season

- ☐ Clean the air filter and then the cover and grille if required.

Technical Service / Warranty

Technical service

Should your appliance fail to work properly and all the instructions for use and installation (especially the section headed "Requirements....") have been carefully observed, then remember that our Technical Service Network is at your full disposal.

When contacting the Technical Service, quote the model code (**E-NR**) and the appliance's factory number (**FD**). This information can be found on characteristics plate.

Warranty

The conditions of warranty depend on the relevant Supplier in a particular country. Contact the establishment where you purchased your appliance for more information and quote the appliance model and factory number. The receipt of purchase for the appliance must be produced prior to any work carried out under warranty.

Things that can save you from making unnecessary phone calls

What to do if ...

The suggestions below will help you to correct minor faults for yourself and save you calls to Technical Services.

If, after checking through these possibilities, the problem remains unsolved, contact our specialised technical service.

... the appliance doesn't work ...

- ☐ Make sure that the appliance is plugged in properly.
- ☐ Make sure that there is power in the mains electricity supply and all the fuses are in working order.
- ☐ Set a lower temperature using the button  .

... the appliance doesn't work and the safety pilot light comes on ...

- ☐ Check that the connection hose is not restricted - it must not be crushed.
- ☐ The outdoor unit should not be positioned or hung more than 1,5 m. above the indoor unit.
- ☐ Place the indoor unit on a flat surface. If the light does not go out, empty the internal water tank. (See instructions in Transport Conditions).

... the appliance operates for a while and then switches off ...

- ☐ Check whether the air inlet or air outlet is blocked.
- ☐ Should the outdoor temperature rise above 43°C, the appliance will turn itself off for a short period of time after which it will then turn itself back on again. Should the temperature in or outside of the room fall below 20°C, the appliance will turn itself off temporarily in order to prevent frost or ice from forming on the evaporator.
- ☐ Make sure that the fast connection is fitted properly.

... the appliance fails to cool the air properly ...

- ☐ Ensure that the window or the door is open as little as possible. This is especially important if the window or door has to be opened slightly for the connection hose.
- ☐ Check that the connection hose is not restricted - it must not be crushed.

... the appliance makes a lot of noise ...

- ☐ Check that the air inlet and outlet are not blocked.
- ☐ If you hear a cyclical water noise, the condensate pump is pumping the water outside.

... the appliance is switched on but the compressor is not running ...

- ☐ The delayed start system is activated each time that the appliance is turned on. The appliance comes on audibly after three minutes.
- ☐ Should the "dehumidification" light flash, then the dehumidification function  has been selected with a room temperature of less than 18°C. The compressor turns itself off (see recommendations and warnings in the "Dehumidification only" section).
- ☐ The ambient temperature must be above 18°C for the appliance to operate in dehumidification and cooling mode.
- ☐ Should "F1" or "F2" appear on the display screen, then a fault has occurred in the thermal probes. Inform the brand's Official Technical Assistance Service!

... the outdoor unit is dripping ...

- ☐ Check that the outdoor unit has been positioned or hung horizontally.
- ☐ Check that the stopper has been inserted correctly.

Warning!

Any other breakdown or repair should be carried out by a specialised technician. In such cases, contact the authorised dealer, the customer attention service or the Technical Services Dept.

Technical Information

Technical information

Consumption at maximum power	1.500W
Fuse	16 A
Cooling capacity *	4.250W
Cooling and dehumidification modes:	
Indoor temperature:	min. +18°C / max. +32°C
Outdoor temperature:	min. +20°C / max. +43°C
* Ashrae 128	

Index

Observations importantes

Mise au rebut de l'emballage45

Mise au rebut de votre ancien appareil45

Avant de connecter votre appareil45

Présentation de votre nouvel appareil

Description de l'appareil46

Panneau de contrôle47

Accessoires47

Conditions d'Utilisation48

Conditions de transport49

Préparatifs

Emplacement de l'unité extérieure50

Communication des unités
intérieure et extérieure51

Séparation du manche à air flexible
dans l'unité intérieure.....52

Union du manche à air flexible à l'unité intérieure 54

Mise en fonctionnement de l'appareil

Réfrigération et Déshumidification55

Seulement déshumidification55

Purification de l'air56

Mise à l'heure/Programmation du temporisateur

Mise à l'heure57

Programmation du temporisateur.....57

Déconnexion du temporisateur.....58

Nettoyage et Maintenance59

Service Technique / Garantie60

**Considérations qui vous éviteront d'appeler le
Service Technique**61

Données techniques63

Observations Importantes

Mise au rebut de l'emballage

- ☐ Respectez l'environnement en mettant l'emballage de votre appareil au rebut.
- ☐ Nos appareils sont soigneusement emballés pour le transport. Les emballages sont conçus dans le but de ne pas porter préjudice à l'environnement. Ils peuvent être recyclés, ce sont des produits écologiques.
- ☐ En recyclant l'emballage, vous contribuez d'une part à l'économie des matières premières, et d'autre part à réduire le volume des déchets.
- ☐ S'il vous l'admet, vous pouvez rendre l'emballage au commerçant qui vous a fourni l'appareil.

Mise au rebut de votre ancien appareil

- ☐ Débranchez l'appareil du réseau et coupez le câble de connexion.
- ☐ Les appareils contiennent des réfrigérants qui doivent être éliminés conformément à la réglementation en vigueur.
- ☐ Remettez votre vieil appareil à un organisme, plutôt que de le mettre au rebut par d'autres moyens. Contactez votre Mairie ou un autre centre compétent pour la reprise de celui-ci.

Avant de connecter votre appareil

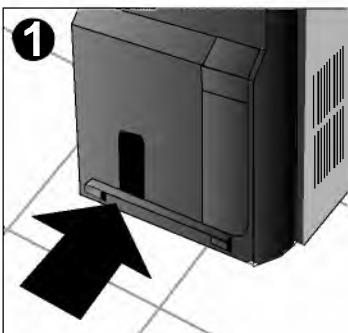

- ☐ Lisez le manuel d'instructions avant de l'utiliser pour la première fois. Il contient des informations importantes, non seulement pour l'utilisation mais aussi pour votre sécurité et la maintenance de l'appareil.
- ☐ Conservez ce manuel d'instructions. Il pourrait éventuellement servir à un autre usager.
- ☐ Ne mettez pas en marche un appareil endommagé.
- ☐ Le montage et la connexion de votre appareil doivent être effectués en accord avec les instructions de montage et la réglementation en vigueur. Si ces instructions ne sont pas respectées, vous courez le risque de perdre les avantages de la garantie.
- ☐ Nos appareils sont fabriqués en accord avec les normes de sécurité en vigueur. Seuls des techniciens compétents en cette matière, sont autorisés à les réparer. Votre sécurité est en jeu.
- ☐ Assurez-vous que les bouchons des déversoirs sont bien posés car ils auraient pu se déboucher au cours du transport. **Fig. 1.**

Présentation de votre nouvel appareil

Description de l'appareil

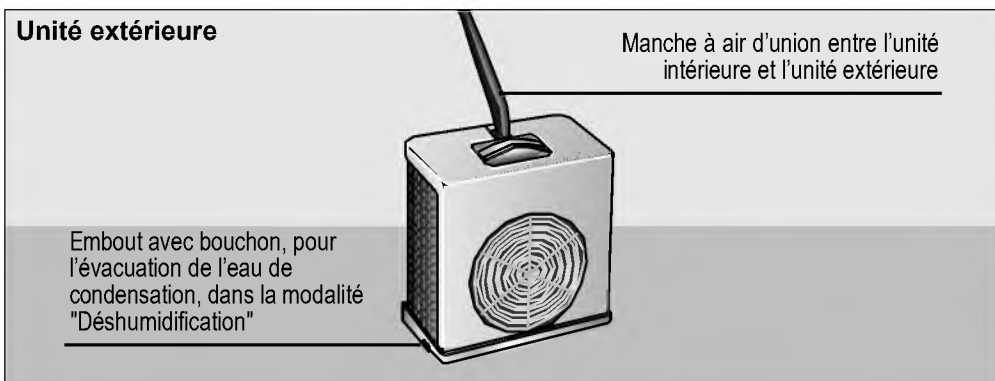
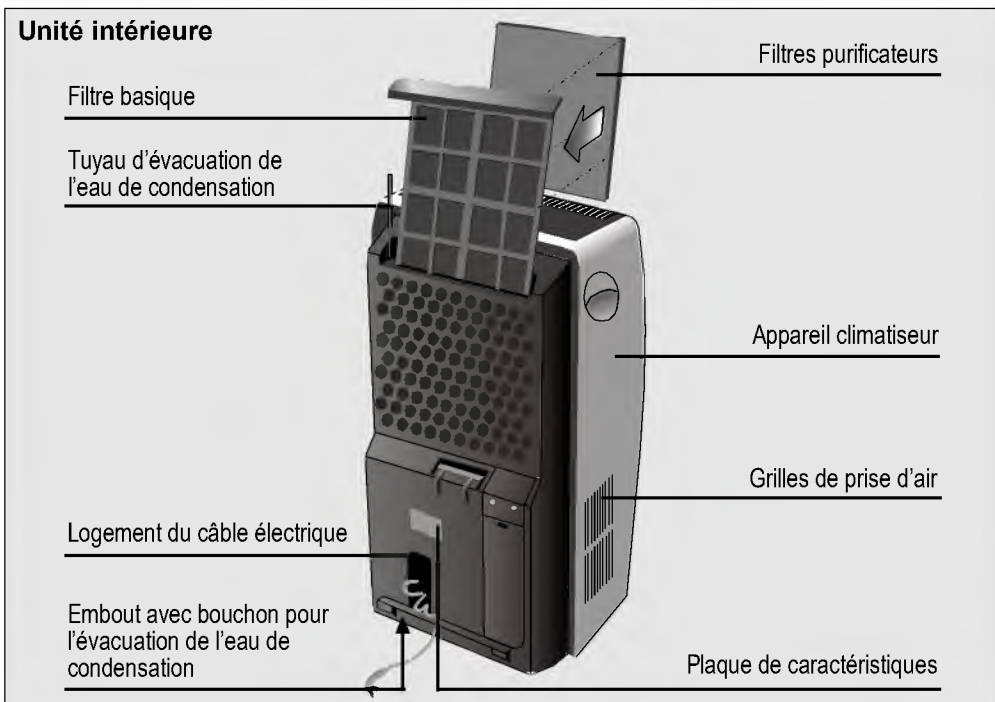

Panneau de contrôle

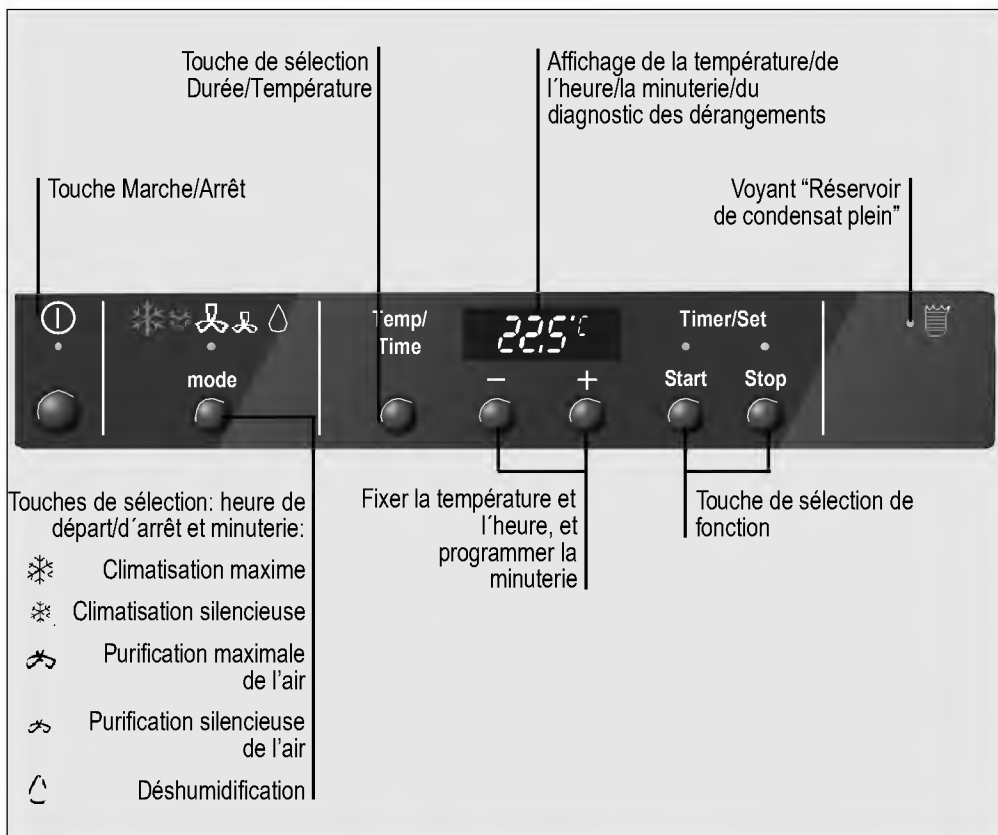

Accessoires

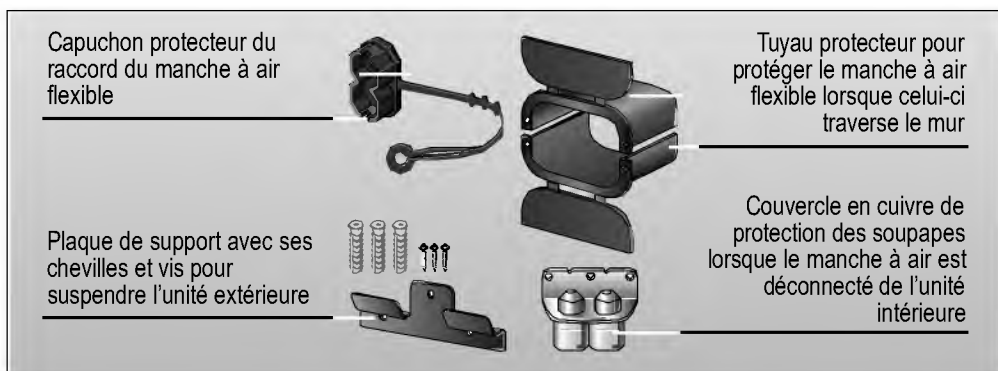

Conditions d'utilisation

Conditions d'utilisation

- ☐ Cet électroménager doit être connecté au réseau à 220/240 V et 50 Hz, par une prise de terre.
- ☐ Protection par le biais d'un fusible de **16 A** d'action lente.
- ☐ Si vous avez besoin d'une rallonge, celle-ci devra être pourvue d'une prise de terre, sa section devra être au moins de 1,5 mm² par borne et sa longueur inférieure à 25 m.
- ☐ Le câble de connexion au réseau électrique dispose d'un logement sur la partie postérieure de l'appareil.
- ☐ Ne permettez pas que de l'eau entre dans l'appareil.
- ☐ Évitez de couvrir les entrées et sorties d'air de votre appareil, spécialement pour la fonction de chauffage.

Si le câble d'alimentation est endommagé, vous devez le substituer par un nouveau câble aux caractéristiques similaires. Pour cela, dirigez-vous au fabricant ou à son service après vente ou le personnel similaire qualifié.

Attention!

Si l'appareil se déconnecte et vous le remettez en marche, le compresseur démarrera à nouveau après environ 3 minutes. Ce laps de temps est nécessaire pour garantir un fonctionnement correct de l'appareil.

